

INLGTO2IRWF

2.1 MP Vandal Proof Fixed Turret Network Camera w/IR, SD Slot

- High quality image with 2MP, 1/2.8" CMOS sensor
- Starlight ultra-high image quality in low light environments
- H.265+ & H.264+ encoding
- 120dB true WDR technology
- Supports Micro SD card up to 256GB
- Smart IR, up to 30m (98ft) IR distance
- Perimeter protection functions: cross-line detection, intrusion detection, area entrance detection, area exit detection

Unify your Security Solution

You asked, we listened. Tailored especially for you, Legend is our **fully NDAA compliant brand**. It offers our latest technologies in a robust build with edge storage capacity. Legend by Inaxsys provides H.265+ compression and easy installation.

Wide Dynamic Range

This camera offers vivid imaging in any scenario. Using industry-leading WDR technology, you'll be able to capture the subject in the most difficult lighting conditions.

On-board Analytics

Smart intrusion prevention systems use advanced technologies to accurately detect and classify targets, such as humans, motor vehicles, and non-motor vehicles. By using algorithms that differentiate between target types, they significantly reduce false alarms caused by environmental factors. These systems provide reliable and effective security solutions for a range of applications and can integrate with other security systems for a comprehensive approach.

*Design and specifications are subjects to change without notice.



LiteAI
Edge Analytics



INLGTO2IRWF

2.1 MP Vandal Proof Fixed Turret Network Camera w/IR, SD Slot

Product Specifications

Camera					
Image Sensor		1/2.8", 2.0 megapixel, progressive scan, CMOS			
Scanning System		Progressive			
Minimum Illumination		Colour: 0.001 lux (F1.6, AGC ON), 0 lux with IR on			
Day/Night		IR-cut filter with auto switch (ICR)			
Electronic Speed Shutter		Auto/Manual, 1 ~ 1/100000s			
Pan/Tilt/Rotate		Pan: 0° ~ 360°	Tilt: 0° ~ 80°	Rotate: 0° ~ 360°	
WDR		120 dB			
S/N Ratio		More than 52 dB			
Illumination					
IR Range		Up to 30m / 98ft			
Wavelength		850nm			
IR On & Off Control		Auto/Manual			
Lens					
Lens Type		Fixed			
Focal Length		2.8mm			
Viewing Angle (H, V, D)		H : 106.7°	V : 57.1°	D : 115.7°	
DORI					
DORI	Lens (mm)	Detect	Observe	Recognize	Identify
Distance	2.8	43.4m/142.4 ft	17.4m/57.1ft	8.7m/28.5ft	4.3m/14.1ft
Video					
Compression		H.265+ / H.265 / H.264 / MJPEG			
H.264 code profile		Baseline profile, Main profile, High profile			
Frame Rate		Main Stream: 2MP (1920*1080), Max 30fps; 720P (1280*720), Max 30fps; Sub Stream: 720P (1280*720), Max 30fps; D1 (720*576), Max 30fps; 640*360, Max 30fps; Third Stream: D1 (720*576), Max 30fps; 640*360, Max 30fps; 2CIF(704*288), Max 30fps; CIF(352*288), Max 30fps;			
Video Bit Rate		128 Kbps~16 Mbps			
On-Screen Display (OSD)		Up to 8 OSDs			
Privacy Mask		Up to 4 areas			
Region of Interest		Up to 8 areas			
Video Stream		Triple			

*Design and specifications are subjects to change without notice.



INLGTO2IRWF

2.1 MP Vandal Proof Fixed Turret Network Camera w/IR, SD Slot

Product Specifications

Image	
White Balance	Auto/Outdoor/Fine Tune/Sodium Lamp/Locked/Auto2
Digital Noise Reduction	2D/3D DNR
Smart IR	Support
Flip	Normal/Vertical/Horizontal/180°/90°Clockwise/90°Anti-Clockwise
Hightlight Compensation (HLC)	Support
Blacklight Compensation (BLC)	Support
Defog	Digital Defog
Artificial Intelligence	
Smart Intrusion Prevention	Support false alarm filtering: Cross Line detection, Intrusion detection, Enter Area detection, Leave Area detection
2 Statistical Analysis	People counting, support people flow counting and crowd density monitoring
Events	
Basic Detection	Motion detection, Ultra motion detection, Tampering alarm, Audio detection
General Function	Watermark, IP address filtering, tampering alarm, alarm input, alarm output, access policy, ARP protection, RTSP authentication, user authentication
Audio	
Audio Compression	G.711U, G.711A
Audio Bit Rate	64 Kbps
Suppression	Support
Sampling Rate	8KHZ
Storage	
Edge Storage	Micro SD, up to 256GB
Network Storage	ANR, NAS(NFS)
Interface	
Built-in Mic	Yes
Ethernet	1 * RJ45 10M/100M Base-TX Ethernet

*Design and specifications are subjects to change without notice.



INLGTO2IRWF

2.1 MP Vandal Proof Fixed Turret Network Camera w/IR, SD Slot

Product Specifications

Network	
Protocols	IPv4, IPv6, IGMP, ICMP, ARP, TCP, UDP, DHCP, PPPoE, RTP, RTSP, RTCP, DNS, DDNS, NTP, FTP, UPnP, HTTP, HTTPS, SMTP, 802.1x, SNMP, QoS, RTMP, SSL/TLS, SSH
Compatibility	ONVIF (Profile S, Profile G, Profile T), API, SDK
User/Host	Up to 32 users. 2 user levels: administrator and common user
Security	Password protection, strong password, HTTPS encryption, Export operation logs, basic and digest authentication for RTSP, digest authentication for HTTP, TLS 1.2, WSSE and digest authentication for ONVIF
Management software	LEGEND VMS, ARKIV
Web Browser	Plug-in required live view: IE 10 and above, Chrome 45 and above, Firefox 52 and above, Edge 79 and above
	Plug-in free live view: Chrome 57.0 and above, Firefox 58.0 and above, Edge 16 and above
Certifications	
EMC	CE-EMC (EN 55032: 2015+A1:2020, EN 61000-3-3: 2013+A1: 2019, EN IEC 61000-3-2: 2019+A1: 2021, EN 55035: 2017+A11:2020) FCC (FCC CFR 47 part 15 B, ANSI C63.4-2014)
Safety	CE LVD (EN 62368-1:2014+A11:2017) CB (IEC 62368-1:2014) UL (UL 62368-1, 2nd Ed., Issue Date: 2014-12-01)
Environment	CE-RoHS (2011/65/EU; (EU)2015/863); WEEE (2012/19/EU); Reach (Regulation (EC) No 1907/2006)
Protection	IP67 (IEC 60529:1989+AMD1:1999+AMD2:2013) 4KV (Surge Protection)
General	
Power	DC 12V±25%, PoE (IEEE 802.3af)
Power Consumption	Less than 5.0W
Power Interface	Ø 5.5mm coaxial power plug
Dimensions (Ø x H)	Ø110.5 x 94.1mm (Ø4.4" x 3.7")
Weight	0.93lb/0.42kg
Material	Metal
Working Environment	-30°C ~ 60°C (-22°F ~ 140°F), Humidity: ≤95% RH (non-condensing)

*Design and specifications are subjects to change without notice.



INLGTO2IRWF

2.1 MP Vandal Proof Fixed Turret
Network Camera w/IR, SD Slot



XLGJB03-G
Junction Box



XLGJB07WM03-G
Wall Mount



XLGUM06-D
Incline Mount



XLGUP06-C
Pole Mount



XLGWM03-D
Wall Mount



XLGCM24
Ceiling Mount



XLGSE24
Pendant Mount



XLGSE24-A
Pendant Mount



VUSD256G
Micro SD Card

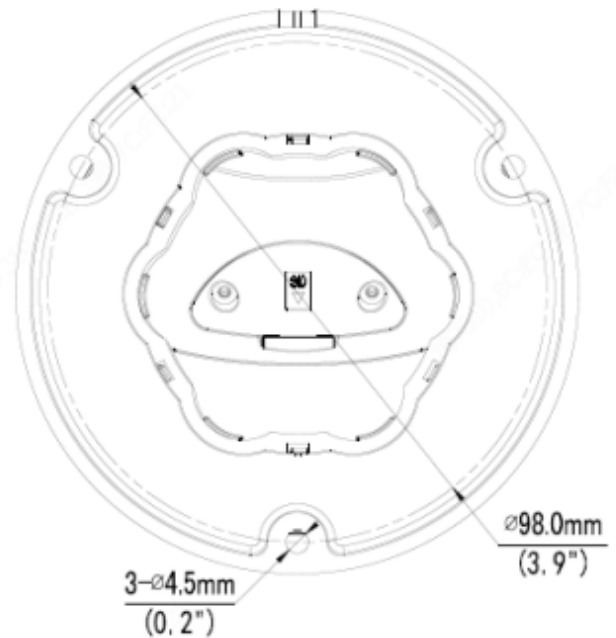
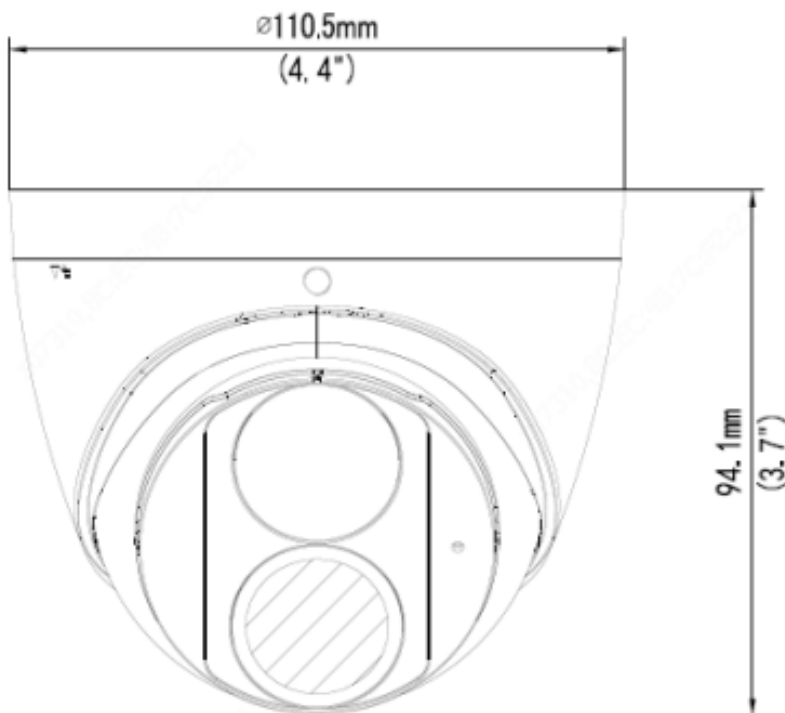

*Design and specifications are subjects to change without notice.



INLGTO2IRWF

2.1 MP Vandal Proof Fixed Turret Network Camera w/IR, SD Slot

Product Specifications

Junction Mount

XLGJB03-G

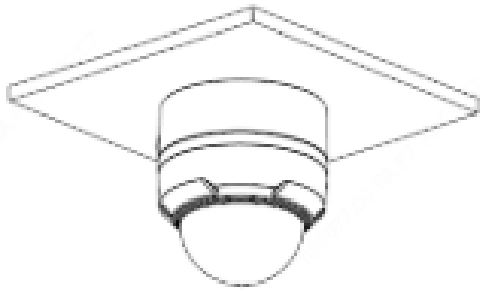

Wall Mount

XLGJB07WM03-G + XLGUP06

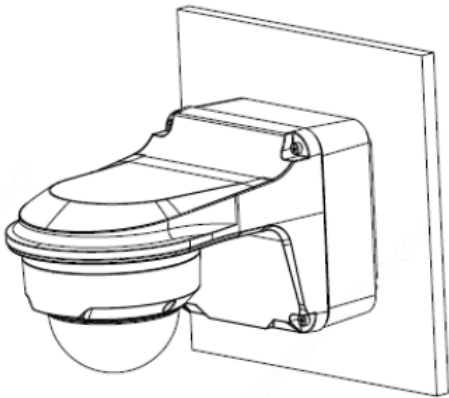

Pendent Mount

XLGCM24 + XLGJB03-G

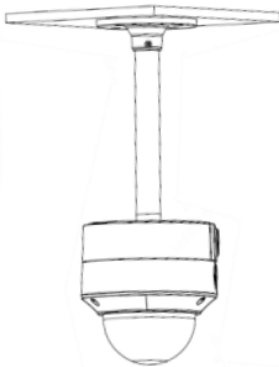

Pole Mount

XLGJB07WM03-G + XLGUP06

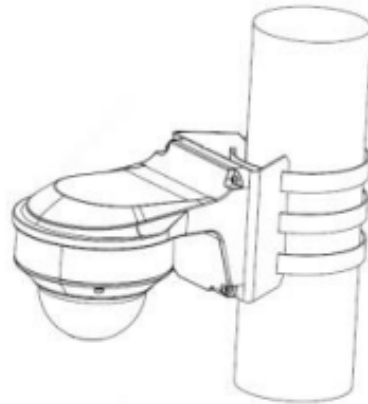

Tilted Mount

XLGUM06-D

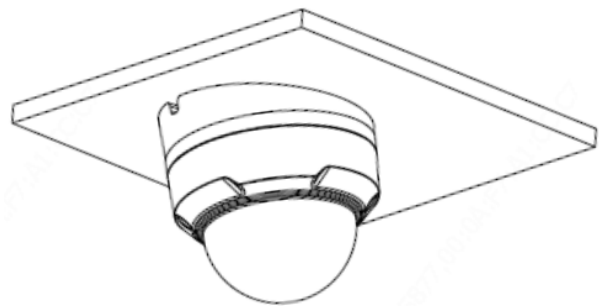

*Design and specifications are subjects to change without notice.

